



SANTOS®



Coffee grinder # 4

**For hotels, bars, restaurants,
institutions, cafeterias,
coffee shops, coffee roasters...**

- **Motor :** Thermal protection
Single phase 220-240 V - 50/60 Hz - 600 W
100-120 V - 50/60 Hz - 650 W
1500 RPM (50 Hz)
1800 RPM (60 Hz)
- **Construction :** stainless steel, sanitary, cast aluminium and painted steel.
- **Weight :** Net : 18 kg (40 lbs)
Shipping : 20 kg (44 lbs)
Packed (box)
- **Dimensions :** Height : 700 mm (28") 590 mm (23")
Width : 220 mm (9") 300 mm (12")
Depth : 320 mm (13") 450 mm (18")
Shipping cube : 0,08 m³ 2,7 Cubic feet
- **Wide range of precision grinding selection** from coarse (filter) to very fine (expresso).
Easy to adjust
- **Ø 63,5 mm special tempered steel grinding discs (burrs)**, long lasting, easy to change.
- **Average output :** 14 kg/hour (31 lbs/hour).
- **Hopper capacity :** 1 kg (2,2 lbs).
- **Normally provided with a bag holder.**
Maximum height of the bag : 280 mm (11").
- **Model with a plastic container (drawer) on request.** Capacity : 800 g (1,8 lbs).
- **Special version for pepper and spices** equipped with a special grinding system (# 4P).
- **Color :** Brown

4

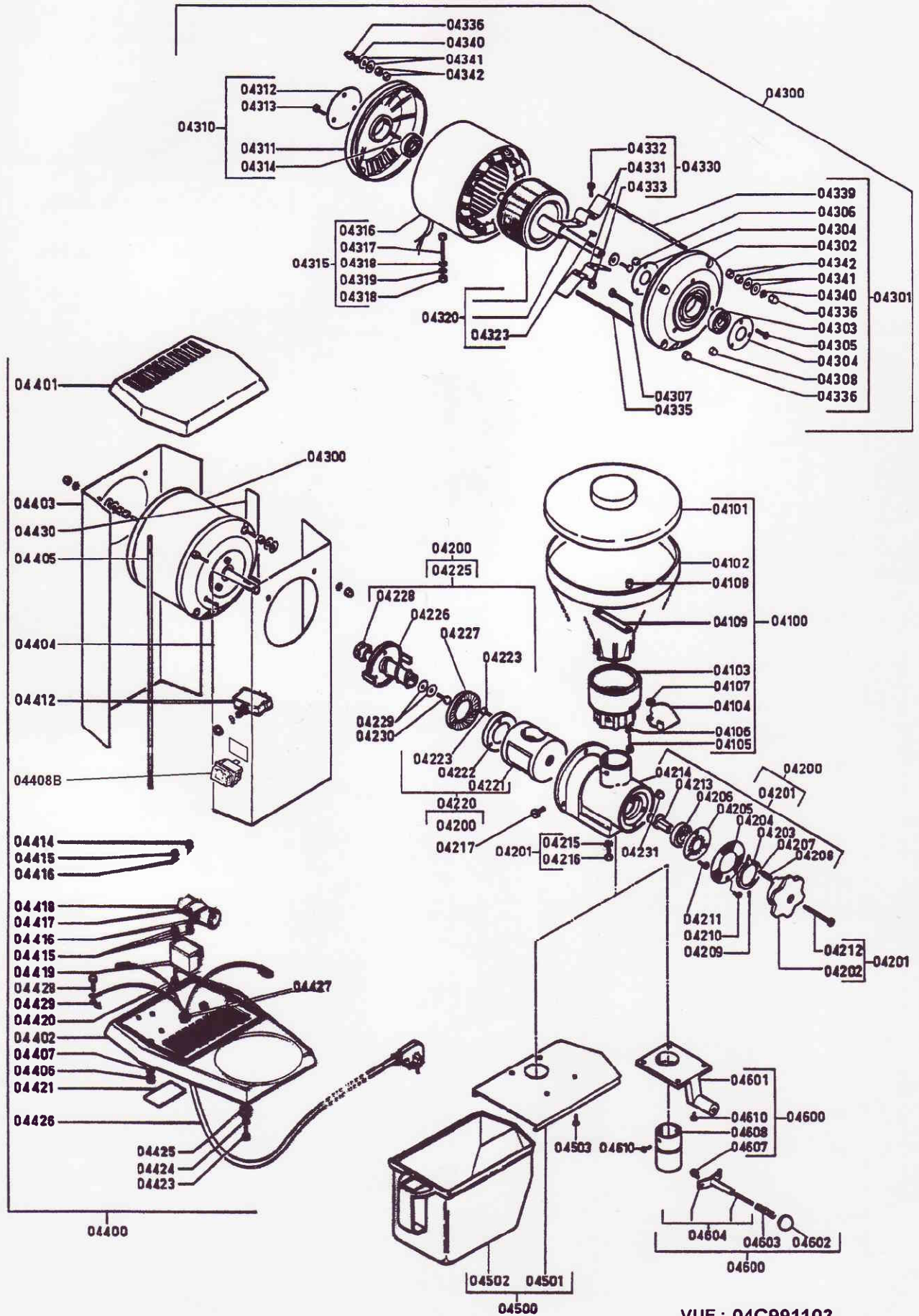

VUE : 04C991103